



# BRIKclad

## MAXUM DRY-STACK



**Maxum Dry-Stack** is a **Canadian made**, large-format **cement bevelled brick** that installs like siding – no mortar required!

Maxum Dry-Stack features a simple, one-step installation method that makes it DIY-friendly and allows for rapid installation\*.

Its versatile design allows for installation by all types of labor across all wall types and in any weather condition.

*\*Use one clip per brick for walls under 30 feet high and two clips per brick for walls 30 feet and taller.*



SET IN BRICK » COAL | Maxum Dry-Stack

### FROM START TO FINISH, THE COMPLETE SYSTEM FOR YOUR NEXT PROJECT!

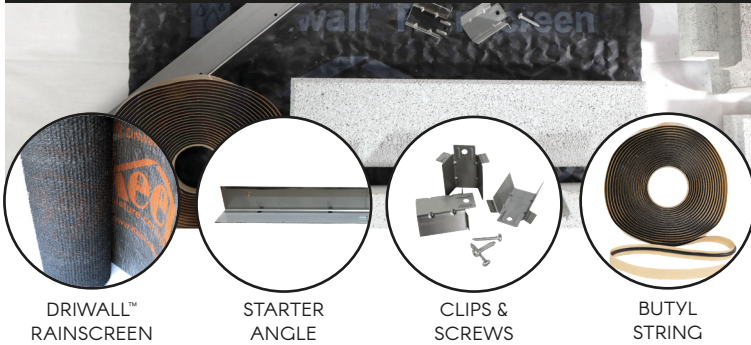

DRIWALL™ RAINSCREEN

STARTER ANGLE

CLIPS & SCREWS

BUTYL STRING

### Specs & Colours



Length: 15.3" | 390 mm  
Height: 3.5" | 90 mm  
Thickness: 1.8" | 45 mm  
Available Colours: 7



COAL



COASTLINE



DOVE WHITE



RIDGEWAY



PENDANT GREY



PHANTOM GREY



FINLAND | SPECIAL ORDER!

**Looking for a mortared look?** Maxum can be installed with a traditional mortared format. We recommend you reach out to your local technical representative for details.

Learn more about Maxum Dry-Stack by contacting your local representative or CSI customer service.

T: 1-800-977-8663 W: [www.AllThingsStone.com](http://www.AllThingsStone.com)

